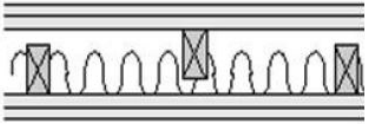
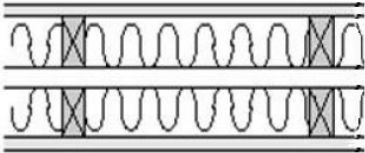

## SIPS with High STC Ratings

### Wall types currently used to achieve required STC ratings.

- STC 55**
- 
- Double 1/2" Type X gypsum wallboard both sides
  - Two rows 2" x 4" studs 16" o.c. or 24" o.c. staggered
  - Absorptive material one side
- STC 57**
- 
- 1/2" Type X gypsum wallboard both sides
  - Two rows 2" x 4" studs 16" o.c. or 24" o.c. on common
  - 2" x 6" plate set 1" apart
  - Absorptive material both sides

### The new fast and efficient sound wall with an hourly rating

**STC 48 or STC 52**

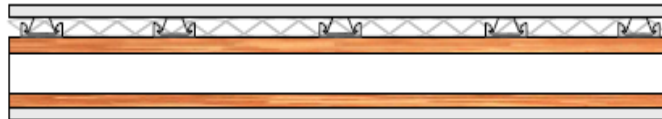

- 5/8" Type X gypsum wallboard both sides
- Premier SIP
- Proprietary sound clip with 2 1/2" batt insulation

**STC 58 or STC 59**

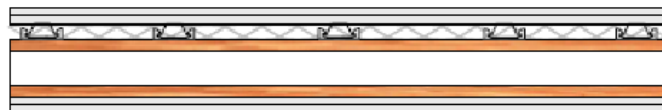

- Double 5/8" Type X gypsum wallboard both sides
- Premier SIP
- Proprietary sound clip with 2 1/2" batt insulation