

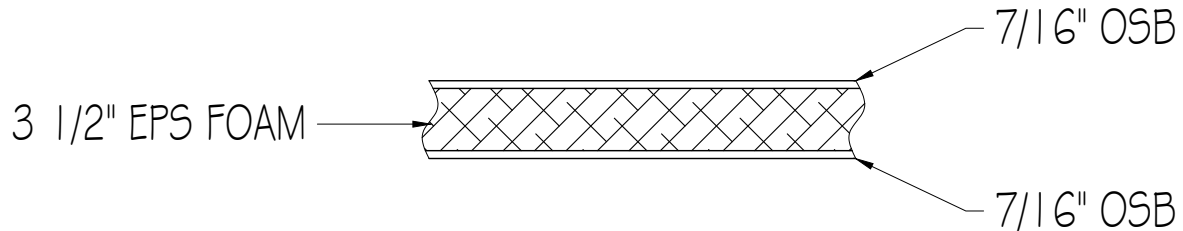

PREMIER 4" STRUCTURAL INSULATED PANEL WALL TYPE A3.5A - R/RSI VALUES



R-VALUES

EXPANDED POLYSTYRENE TYPE I (EPS)

COMPONENT	R-VALUE
7/16" ORIENTED STRAND BOARD	0.6
TYPE I EPS (*R - 4.17 PER INCH @ 4° C)	14.6
7/16" ORIENTED STRAND BOARD	0.6
TOTAL:	15.8

* R-VALUES BASED ON ASTM C518

RSI-VALUES

EXPANDED POLYSTYRENE TYPE I (EPS)

COMPONENT	RSI-VALUE
7/16" ORIENTED STRAND BOARD	0.11
TYPE I EPS (*RSI - 0.73 PER INCH @ 4° C)	2.57
7/16" ORIENTED STRAND BOARD	0.11
TOTAL:	2.79

* RSI-VALUES BASED ON ASTM C518

PLATINUM GRAPHITE POLYSTYRENE TYPE I (GPS)

COMPONENT	R-VALUE
7/16" ORIENTED STRAND BOARD	0.6
TYPE I GPS (*R - 4.9 PER INCH @ 4° C)	17.2
7/16" ORIENTED STRAND BOARD	0.6
TOTAL:	18.4

* R-VALUES BASED ON ASTM C518

PLATINUM GRAPHITE POLYSTYRENE TYPE I (GPS)

COMPONENT	RSI-VALUE
7/16" ORIENTED STRAND BOARD	0.11
TYPE I GPS (*RSI - 0.86 PER INCH @ 4° C)	3.03
7/16" ORIENTED STRAND BOARD	0.11
TOTAL:	3.25

* RSI-VALUES BASED ON ASTM C518



PREMIER 6" STRUCTURAL INSULATED PANEL WALL TYPE A5.5A - R/RSI VALUES

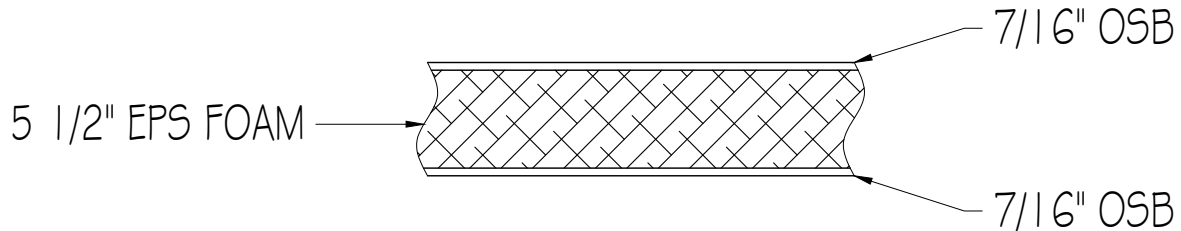

R-VALUES

RSI-VALUES

EXPANDED POLYSTYRENE TYPE I (EPS)

EXPANDED POLYSTYRENE TYPE I (EPS)

COMPONENT	R-VALUE
7/16" ORIENTED STRAND BOARD	0.6
TYPE I EPS (*R - 4.17 PER INCH @ 4° C)	23.0
7/16" ORIENTED STRAND BOARD	0.6
TOTAL:	24.2

COMPONENT	RSI-VALUE
7/16" ORIENTED STRAND BOARD	0.11
TYPE I EPS (*RSI - 0.73 PER INCH @ 4° C)	4.05
7/16" ORIENTED STRAND BOARD	0.11
TOTAL:	4.27

* R-VALUES BASED ON ASTM C518

* RSI-VALUES BASED ON ASTM C518

PLATINUM GRAPHITE POLYSTYRENE TYPE I (GPS)

PLATINUM GRAPHITE POLYSTYRENE TYPE I (GPS)

COMPONENT	R-VALUE
7/16" ORIENTED STRAND BOARD	0.6
TYPE I GPS (*R - 4.9 PER INCH @ 4° C)	27.0
7/16" ORIENTED STRAND BOARD	0.6
TOTAL:	28.2

COMPONENT	RSI-VALUE
7/16" ORIENTED STRAND BOARD	0.11
TYPE I GPS (*RSI - 0.86 PER INCH @ 4° C)	4.75
7/16" ORIENTED STRAND BOARD	0.11
TOTAL:	4.97

* R-VALUES BASED ON ASTM C518

* RSI-VALUES BASED ON ASTM C518



PREMIER 8" STRUCTURAL INSULATED PANEL WALL TYPE A7.25A - R/RSI VALUES

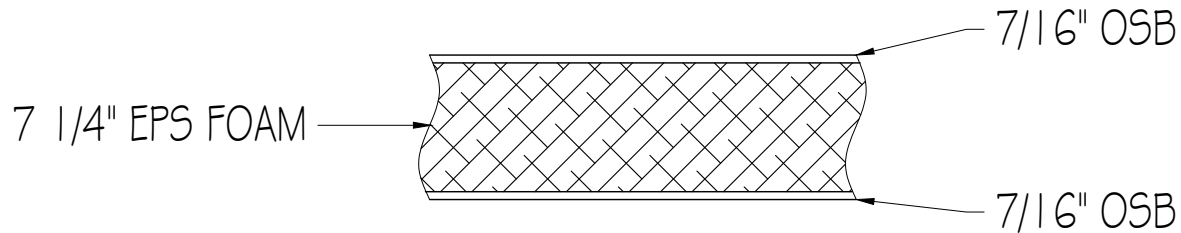

R-VALUES

EXPANDED POLYSTYRENE TYPE I (EPS)

COMPONENT	R-VALUE
7/16" ORIENTED STRAND BOARD	0.6
TYPE I EPS (*R - 4.17 PER INCH @ 4° C)	30.2
7/16" ORIENTED STRAND BOARD	0.6
TOTAL:	31.4

* R-VALUES BASED ON ASTM C518

RSI-VALUES

EXPANDED POLYSTYRENE TYPE I (EPS)

COMPONENT	RSI-VALUE
7/16" ORIENTED STRAND BOARD	0.11
TYPE I EPS (*RSI - 0.73 PER INCH @ 4° C)	5.32
7/16" ORIENTED STRAND BOARD	0.11
TOTAL:	5.54

* RSI-VALUES BASED ON ASTM C518

PLATINUM GRAPHITE POLYSTYRENE TYPE I (GPS)

COMPONENT	R-VALUE
7/16" ORIENTED STRAND BOARD	0.6
TYPE I GPS (*R - 4.9 PER INCH @ 4° C)	35.5
7/16" ORIENTED STRAND BOARD	0.6
TOTAL:	36.7

* R-VALUES BASED ON ASTM C518

PLATINUM GRAPHITE POLYSTYRENE TYPE I (GPS)

COMPONENT	RSI-VALUE
7/16" ORIENTED STRAND BOARD	0.11
TYPE I GPS (*RSI - 0.86 PER INCH @ 4° C)	6.25
7/16" ORIENTED STRAND BOARD	0.11
TOTAL:	6.47

* RSI-VALUES BASED ON ASTM C518



PREMIER 10" STRUCTURAL INSULATED PANEL WALL TYPE A9.25A - R/RSI VALUES

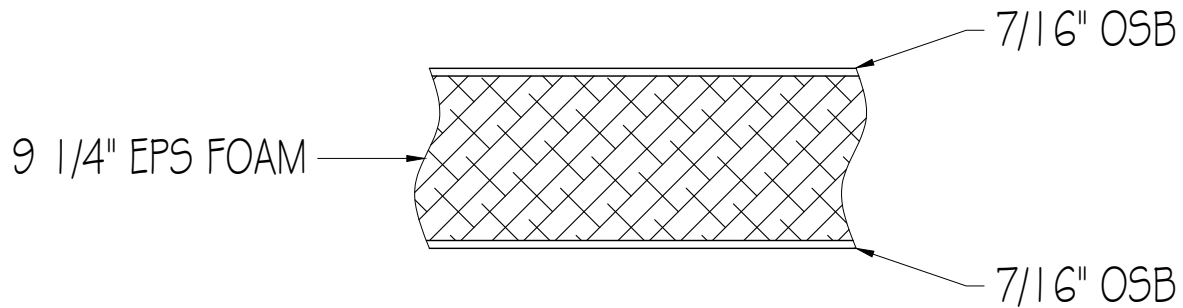

R-VALUES

EXPANDED POLYSTYRENE TYPE I (EPS)

COMPONENT	R-VALUE
7/16" ORIENTED STRAND BOARD	0.6
TYPE I EPS (*R - 4.17 PER INCH @ 4° C)	38.6
7/16" ORIENTED STRAND BOARD	0.6
TOTAL:	39.8

* R-VALUES BASED ON ASTM C518

RSI-VALUES

EXPANDED POLYSTYRENE TYPE I (EPS)

COMPONENT	RSI-VALUE
7/16" ORIENTED STRAND BOARD	0.11
TYPE I EPS (*RSI - 0.73 PER INCH @ 4° C)	6.80
7/16" ORIENTED STRAND BOARD	0.11
TOTAL:	7.02

* RSI-VALUES BASED ON ASTM C518

PLATINUM GRAPHITE POLYSTYRENE TYPE I (GPS)

COMPONENT	R-VALUE
7/16" ORIENTED STRAND BOARD	0.6
TYPE I GPS (*R - 4.9 PER INCH @ 4° C)	45.3
7/16" ORIENTED STRAND BOARD	0.6
TOTAL:	46.5

* R-VALUES BASED ON ASTM C518

PLATINUM GRAPHITE POLYSTYRENE TYPE I (GPS)

COMPONENT	RSI-VALUE
7/16" ORIENTED STRAND BOARD	0.11
TYPE I GPS (*RSI - 0.86 PER INCH @ 4° C)	7.98
7/16" ORIENTED STRAND BOARD	0.11
TOTAL:	8.20

* RSI-VALUES BASED ON ASTM C518



PREMIER 12" STRUCTURAL INSULATED PANEL WALL TYPE A11.25A - R/RSI VALUES

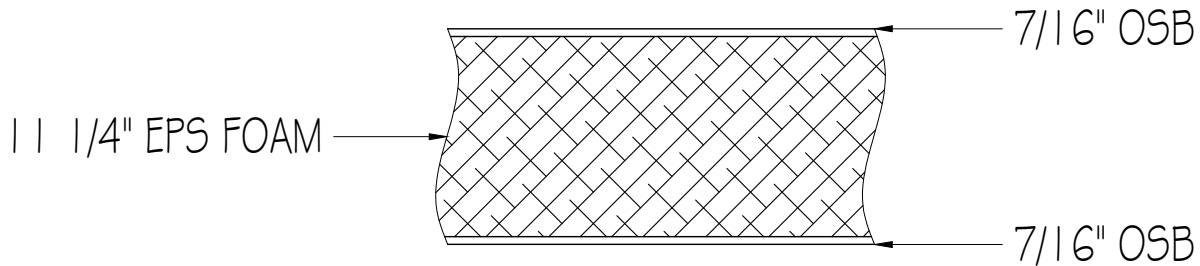

R-VALUES

EXPANDED POLYSTYRENE TYPE I (EPS)

COMPONENT	R-VALUE
7/16" ORIENTED STRAND BOARD	0.6
TYPE I EPS (*R - 4.17 PER INCH @ 4° C)	46.9
7/16" ORIENTED STRAND BOARD	0.6
TOTAL:	48.1

* R-VALUES BASED ON ASTM C518

RSI-VALUES

EXPANDED POLYSTYRENE TYPE I (EPS)

COMPONENT	RSI-VALUE
7/16" ORIENTED STRAND BOARD	0.11
TYPE I EPS (*RSI - 0.73 PER INCH @ 4° C)	8.26
7/16" ORIENTED STRAND BOARD	0.11
TOTAL:	8.48

* RSI-VALUES BASED ON ASTM C518

PLATINUM GRAPHITE POLYSTYRENE TYPE I (GPS)

COMPONENT	R-VALUE
7/16" ORIENTED STRAND BOARD	0.6
TYPE I GPS (*R - 4.9 PER INCH @ 4° C)	55.1
7/16" ORIENTED STRAND BOARD	0.6
TOTAL:	56.3

* R-VALUES BASED ON ASTM C518

PLATINUM GRAPHITE POLYSTYRENE TYPE I (GPS)

COMPONENT	RSI-VALUE
7/16" ORIENTED STRAND BOARD	0.11
TYPE I GPS (*RSI - 0.86 PER INCH @ 4° C)	9.70
7/16" ORIENTED STRAND BOARD	0.11
TOTAL:	9.92

* RSI-VALUES BASED ON ASTM C518